

Your abode next to  
nature & divinity

# Anāntara

a project by **SHAMRĀO** builders







# Peace Within

Anantara is a premium residential-cum-commercial project in the quaint and blessed folds of urban Ponda. Strategically located, the one & two BHK apartment project is proximate to important business and civil amenities centres while affording expansive vistas of green rolling hills. Only a short distance from the centuries-old Mahalakshmi Temple, Anantara offers its residents a unique opportunity to live in thoughtfully articulated modern spaces amidst a cloud of serene tranquility and spirituality.





# Convenient Living

Designed to meet the needs of modern luxury living with comfort and safety, the project is built on the earthquake-resistant RCC framed structure and is constructed using superior quality building materials. It also offers amenities such as elevators, 24X7 water supply, power backup, green spaces and designated parking spots. Shining bright in the oasis of darkness at night, Anantara is well lit and hosts dedicated security personnel and surveillance systems.





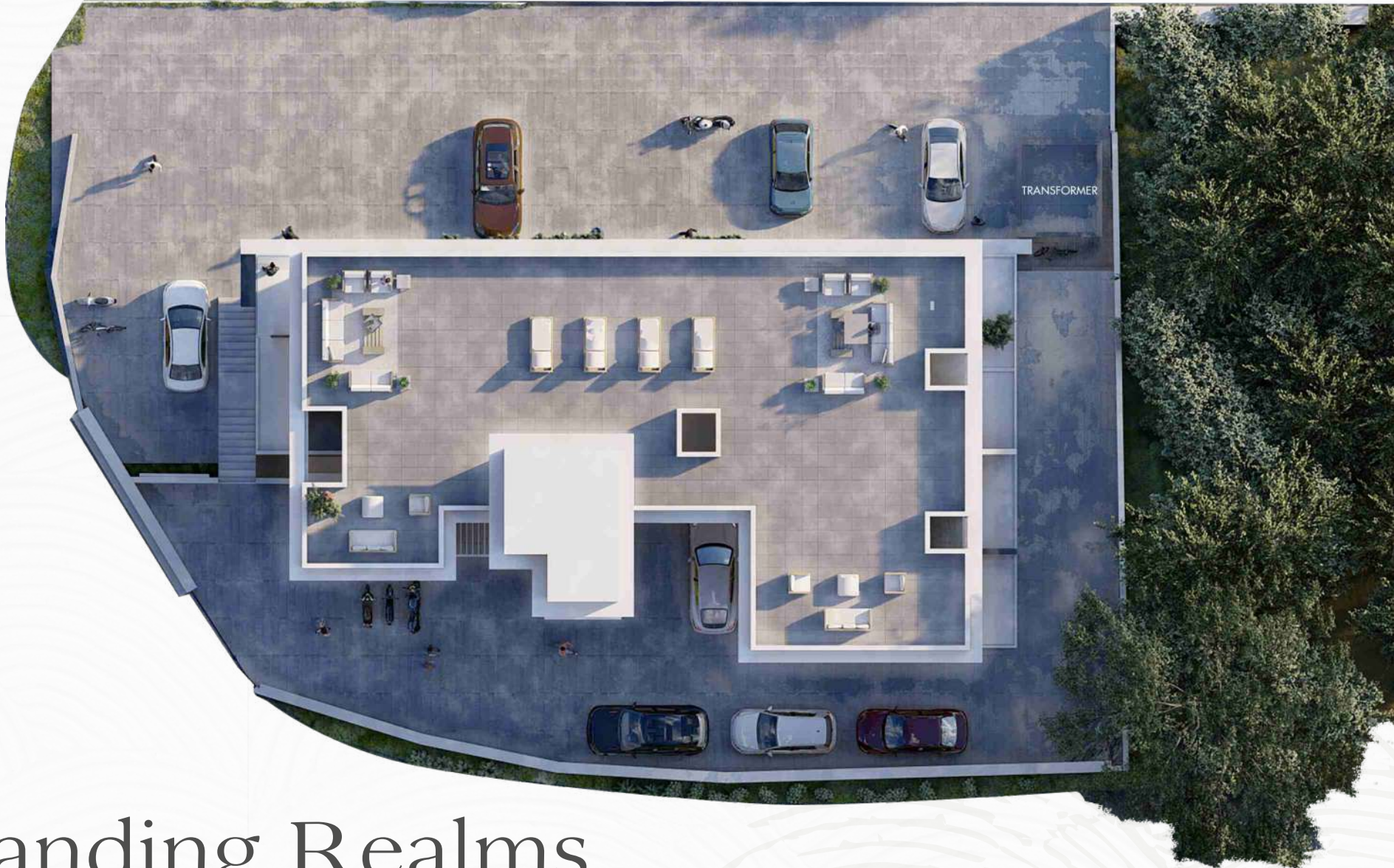

# Expanding Realms

Anantara offers a sense of seamless living space with its wide balconies and open terraces. The project also has a rooftop sitting area with shared access for all residents. Imagine enjoying your morning coffee or evening tea with your loved ones on the balcony or terrace as the Sun swims through the ocean of sky, leaving trails of breathtaking hues! Enjoy the open spaces to entertain guests, do Yoga or work out, or simply sit and chat for hours.







SHAMRÃO  
Sua Vida em Primeiro







# Tasteful Living

The elegantly designed living and dining space give you the freedom to set an ambience of your choice. There's ample room for your exquisite furniture and favourite showpieces. The concealed conducting with strategic outlets helps you easily connect your TV and Sound system, and the vitrified flooring renders a suffused glow to your living and dining space.





# Dreams & Stars

Intimate and cosy, the bedrooms at Anantara are equipped with provisions for installing air conditioners and TV sets. The exquisite flooring and soothing paint finish of the walls help in creating a favourable sleep environment.



One of the highlights of the project, the terrace augments the living space and enhances the quality of life. What all you can do with this space – set up a small bar, turn it into a green space, or put patio furniture? You may let your imagination run wild!







# Relish for Life

Delectable memories are dished out in the kitchen of a happy home. At Anantara, we bring you kitchen spaces that are designed to offer optimum convenience while cooking. A smooth granite slab fitted with a sink, power outlets for various electrical appliances, such as the refrigerator, microwave, mixer blender, and induction, and a convenient provision for setting up the gas stove are some of the key attributes of the spacious kitchen. The kitchen offers easy, unobstructed space to help a busy cook move around swiftly.





# Lower Ground

## Floor Plan

SR NO.	SHOP NO.	CARPET AREA	COLOUR
1	SHOP 01	22.74 sq m	Light Blue
2	SHOP 02	24.64 sq m	Light Blue
3	SHOP 03	21.19 sq m	Light Orange
4	SHOP 04	21.12 sq m	Light Orange
5	SHOP 05	19.01 sq m	Light Orange
6	SHOP 06	21.19 sq m	Light Orange
7	SHOP 07	23.23 sq m	Light Blue
8	SHOP 08	24.64 sq m	Light Blue
9	SHOP 09	22.81 sq m	Light Blue

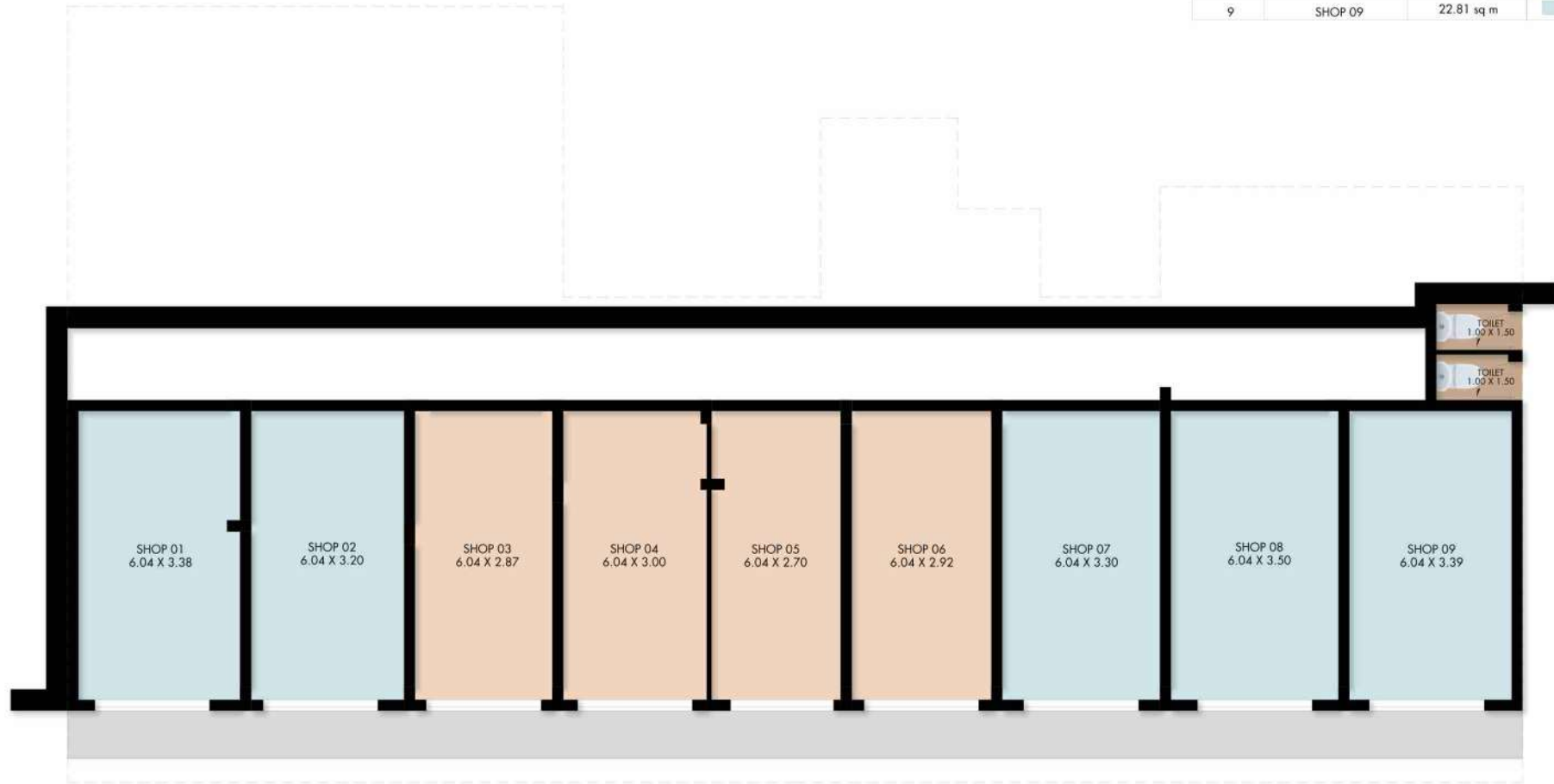



# Upper Ground

## Floor Plan

SR NO.	FLAT NO.	CARPET AREA	COLOUR
10	101 (2BHK)	100.49 sq m	Orange
11	102	59.58 sq m	Yellow
12	103	69.82 sq m	Light Blue
13	104	70.10 sq m	Light Blue





# First

## Floor Plan

SR NO.	FLAT NO.	CARPET AREA	COLOUR
14	201 (2BHK)	76.17 sq m	
15	105	56.49 sq m	
16	106	53.77 sq m	
17	107	54.02 sq m	





# Second

## Floor Plan

SR NO.	FLAT NO.	CARPET AREA	COLOUR
18	301 (2BHK)	79.15 sq m	Light Blue
19	302	59.58 sq m	Light Yellow
20	303	56.37 sq m	Light Yellow
21	304	57.58 sq m	Light Yellow





Key specifications for

# Shops

## Structure

The building will be RCC framed structure.

## Masonry Walls

Shall be of Blocks / Laterite finished with cement plaster.

## Painting

Internal walls shall be finished with wall putty and premium finish of or equivalent. External walls shall be finished with water proof paints.

## Electrification

\* Single phase meter \* 2 fan Points \* 2 light Points \* 2 15A Points \* 2 5A Points

## Power Supply

Single phase connection will be provided for commercial.

## Shutter

Aluminum rolling shutter will be provided for shop.

## Flooring

Glazed / Matte finish / Vitrified flooring & vitrified skirting will be provided

## Amenities

Separate Ladies and Gents toilets will be provided at ground level.





## Key specifications for

# Flats

## Structure

The building will be RCC framed structure.

## Masonry Walls

Shall be of Blocks / Laterite finished with cement plaster.

## Painting

Internal walls shall be finished with wall putty and premium finish of or equivalent. External walls shall be finished with water proof paints.

## Electrification

\* Bedroom - 2 light points, 1 fan point   \* AC provisions made in all bedrooms.   \* Inverter points shall be provided.   \* Kitchen shall have two socket - 15A for kitchen appliances, 2 points of 5A, 2 light points & 1 fan point.   \* Terrace / balcony shall have 1 light point.   \* Suitable concealed conducting shall be done for TV in living & each bedroom.   \* All wiring shall be done in Finolex, Polycab or equivalent brand.

## Power Supply

Single phase connection will be provided for residential.

## Windows

Shall have granite framing with powder coated aluminum windows, bathroom windows shall have glass louvers.

## Waterproofing

Shall be done in every bathroom and open terraces (if applicable)

## Doors

All door shall have laminated flush door, with wooden frames and appropriate locking system.



## Flooring

Vitrified flooring & vitrified skirting will be provided in all the rooms.

## Bathrooms

Shall have antiskid ceramic flooring and ceramic tiles on walls. Sanitary ware and CP fittings shall be of Jaguar or equivalent.

## Balcony

Shall have ceramic flooring, hand railing at the edges for safety.

## Kitchen Area

Shall have granite platform with S.S. sink and dado of 60 cm height above platform.

---

# Amenities

## Structure

Is Earthquake resistance RCC frame work.

## Lift

Lift shall be provided

## Gated Complex

Entire Area shall be secured by boundary walls & R.C.C. Retaining Walls. Designer Main gate and Exit gate shall be provided.

## Landscaping

Landscaping will be provided.

## Water Tank

Overhead and Underground Water tanks shall be provided with adequate water capacity with automated pumping facility.

## Parking

dedicated parking space will be provided Common parking space will be provided for visitors.







**SHĀMRĀO**

TRADITION OF TRUST

**Anāntara**

Bandora - Ponda  
Goa

---

Website: [www.shamraobuilders.in](http://www.shamraobuilders.in)

M: +91 9607744334 | +91 9823564334

Email: [shamraobuilders@gmail.com](mailto:shamraobuilders@gmail.com)

---

RCC Consultant: B. S. Sukthankar

Architect: Coplanar Studio